

Ashley Hill

MONTPELIER

APPROXIMATE FLOOR AREA
65 SQM / 700 SQFT

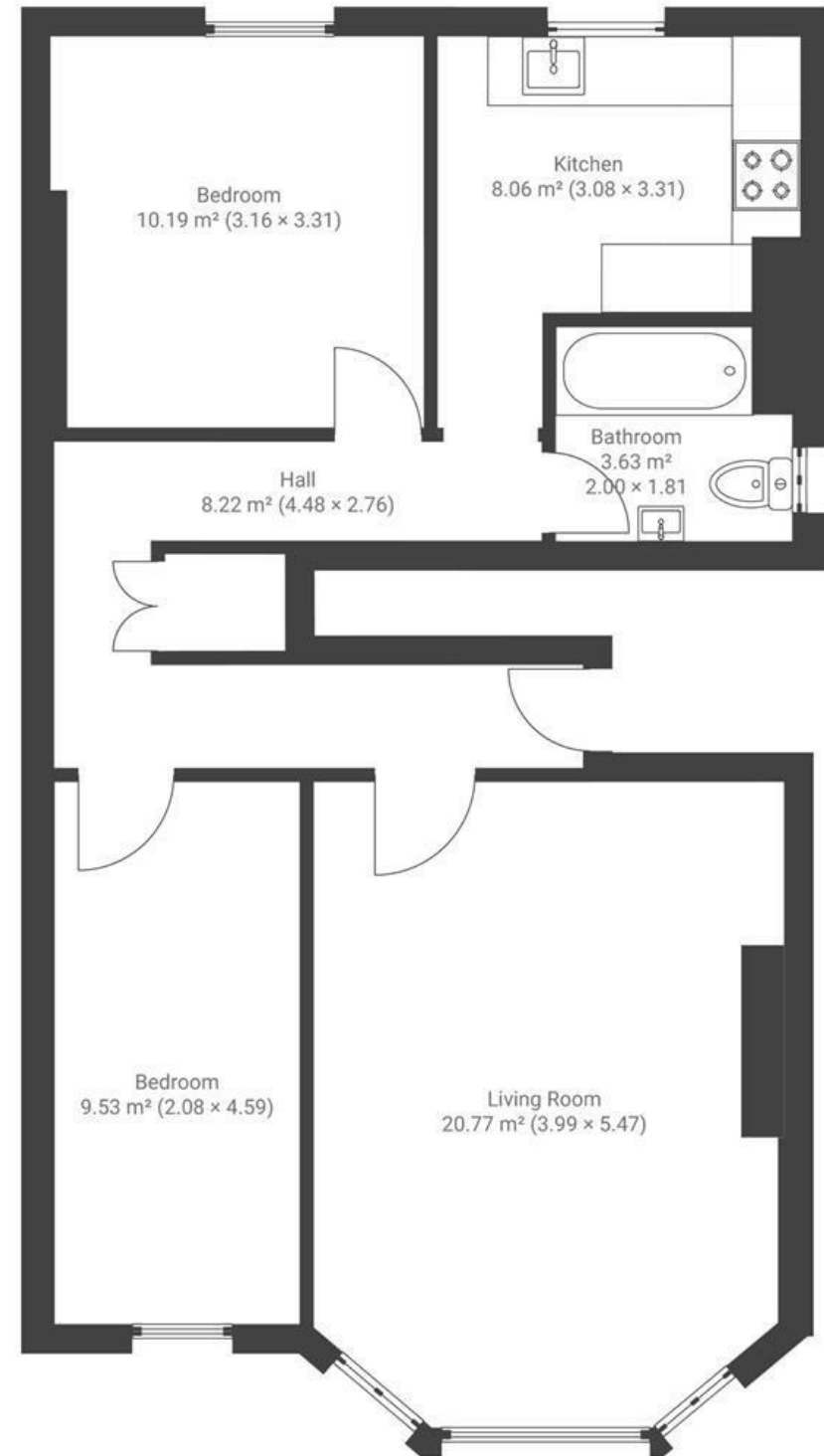

Boardwalk

Ashley Hill

, BRISTOL



£325,000



2 Bedrooms



BS7 9BE



1 Bathrooms

"I've loved sitting in the lounge on a sunny morning looking at the wonderful view across Narrowways Nature Reserve and beyond. Watching balloons, fireworks on New Years Eve or even just the changing of the seasons is something I'll really miss. It's a space that naturally brings people together, and I've shared some really special moments here."

